

- 1 Display for relay function
- 2 Descriptive text for relay function
- 3 Digital values and descriptive text displays
- 4 Unit of display
- 5 Key for setpoint and parameter mode
- 6 Setpoint adjustment

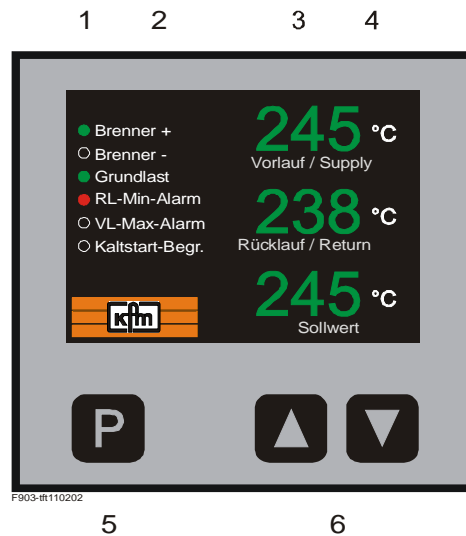

**General:**

With remote devices 903A50 controller types 903 / 93 with option 99sre can be remotely operated, i.e. all operations can take place at the controller as well as at the remote control device resp. all indications are visible on both.

In the attempt of simultaneous operation the device which was operated first has priority. At this device the operation can be continued normally, at the other device the operation is blocked. But at any time on the displays of both devices identical contents are indicated. After the used menu level of the prior device has been left, operation is possible at both devices.

Depending on type, keys can be integrated in the remote device or routed to the terminals for connecting external keys.

The connection to the controller with option 99sre is realised by a patch cable. The remote device can be connected in a maximum distance up to 100 m.

**Types**

Remote device standard version, power supply 100...250V AC  
Remote device standard version, power supply 24V DC

**Li.No.**

**903A500**  
**903A508**

**Flow chart:** (Examples, single remote device / two remote devices connected via a switch.)

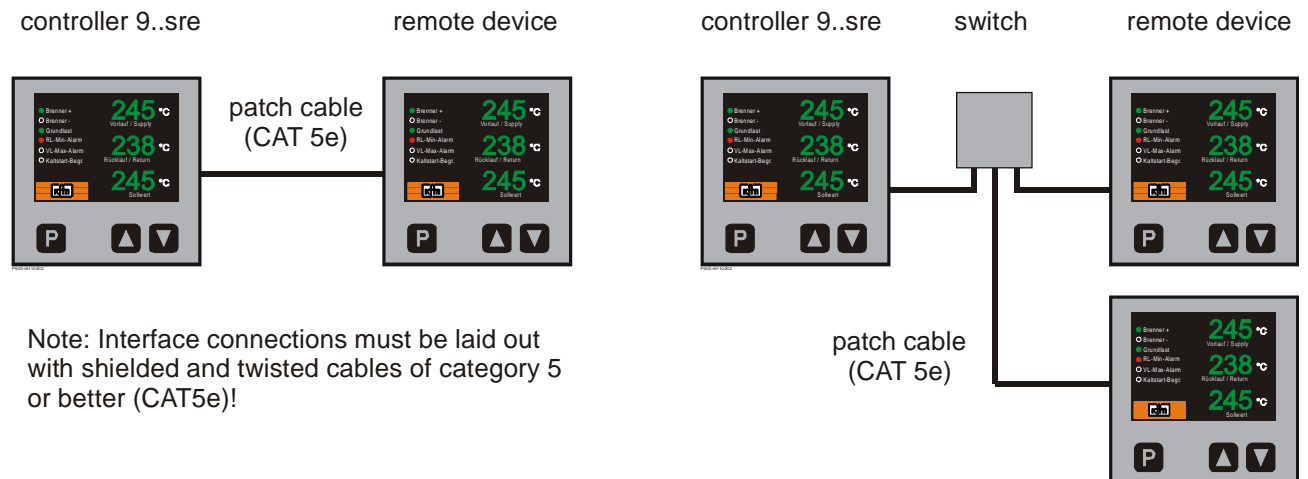

Note: Interface connections must be laid out with shielded and twisted cables of category 5 or better (CAT5e)!

**Hints for setup-level:** The setup-level is entirely for the *configuration of the remote device* and is only used exceptionally for adjustment of contrast and brightness of the background illumination, resp. for the configuration of different bus addresses when using two remote devices. The control of the connected controller in the operating mode is possible automatically after leaving the setup-level.



Press and hold the **P** - button, switch on power supply

A frame with the description „SETUP“ shows the activated setup-level.

Release **P** - button,

*continue* to the next parameter and/or *confirm* entry:

*briefly* press each time the **P** - button

To *change* the setting displayed: Press the **▼...▲** button

**Settings in detail:**

(existence depends on version and type):

		Factory setting:	Notes
<b>Adr</b>	bus address (0...10)	5	—
<b>BRIG</b>	Brightness adjustment for display remote device (0 ... 100)	50	—

*return to operating mode:*  
*briefly* press the **P**- button

**Error messages:**

**OFFLINE**      Fault on remote interfaces, data link interrupted.  
 Check the patch cable and the controller 9.. power supply.

**Technical data / Installation dimensions**

**903A50.:**

Housing: for panel mounting, 96x96mm  
 Power supply:24 VDC,alt. 100..250VAC,app. 2 VA  
 Protect. system (DIN EN 60529):  
 IP 54 (terminals IP 20)  
 Permissible ambient temperature: 0...60°C  
 Nominal temperature: 20°C  
 Climatic category: relative humidity <= 75 %  
 yearly average, no condensation  
 EMC: refer to EN 61326  
 Interface: Ethernet 10Base-T or 100Base-TX  
 (autom. baudrate detect.), max. length 100 m

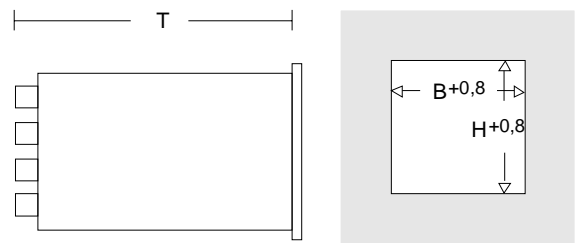

H=92mm, B=92mm, T=150mm alternative 70mm

**Wiring diagrams:**

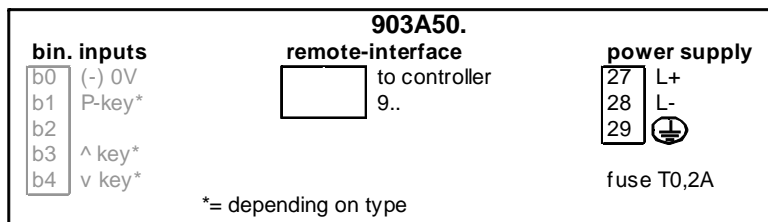

(Examples, valid for each device is the wiring diagram on its casing only)